

DOOSUNG METAL CO.,LTD

Reliable company for clients
Management for creating new values

www.ds7.co.kr
DOOSUNG METAL CO.,LTD.



 **두성금속(주)**

514-12 Wondangdae-ro, Seo-gu, Incheon-si, Korea (196-9, Wanggil-dong)
Tel. +82-32-565-0287~9 Fax. +82-32-563-6840 E-mail. ds7@ds7.co.kr

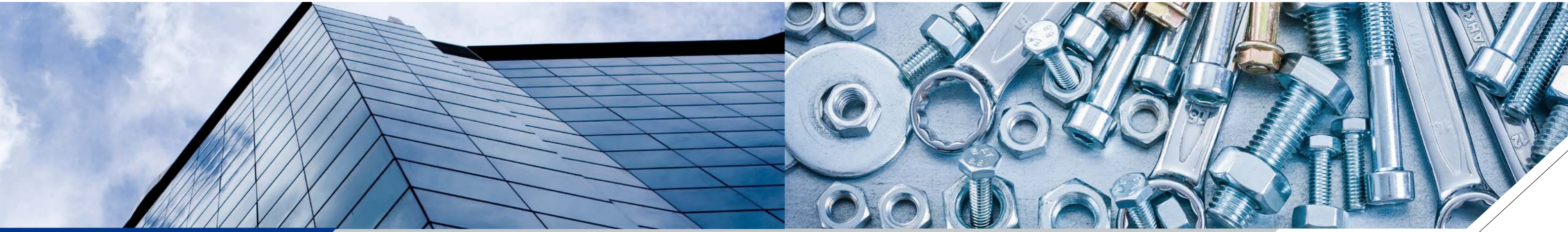

DOOSUNG METAL CO.,LTD

INTROCUCTION

Our company was established in 1981 exerting the greatest effort to produce bolt, nut, and metal products.

Bolt products are the longest metal item in the history of mankind and have also been closely related to humans longer than any other products.

Placing priority on consumers all the times, we will make our best to pursue harmony, honesty, and responsibility and become a reliable company for clients by focusing on the development of high quality and new products.

Support and concern will be much appreciated.

Doosung Metal Co., Ltd.
CEO, Gwangbae Kim

HISTORY

- | | | | |
|-------------|--|-------------|--|
| 1983 | • Established Doosung Electricity Company as license number 256 | 2009 | • Established the 2nd factory in Moondeung Doosung Metal in Shandong, China |
| 1987 | • Established Doosung Bolt | 2009 | • Registered as a venture company 2009-0223535 |
| 1993 | • Purchased the building for Doosung Bolt Inspecting Factory | 2010 | • Certified as the research and development department |
| 1997 | • Registered for Doosung Bolt Factory | 2010 | • 60132 certificate as a clean business area |
| 1998 | • Joined Korea Metal Industry Cooperative | 2012 | • Registered as a managerial innovative small and medium company 120702-00698 |
| 1999 | • 91-046-22 for different types of business in Small and Medium Business Corporation | 2012 | • Selected as an outstanding products from small and medium company in Seogu, Incheon, Korea |
| 1999 | • Certified with ISO in Korea Quality Certificate Center (AC-01898) | 2014 | • Established 2nd factory in Gimpo in September • 2nd factory in Gimpo at 162-2 Daebyeok-ri, Daegot-myeon, Gimpo-si, Korea |
| 2000 | • Selected as an outstanding company by Kookmin Bank | 2015 | • Selected as an outstanding company for creating an opportunity for employment • Technological innovative small and medium companies (INNO-BIZ) certificate • Registered with patents and utility model |
| 2001 | • Small and Medium Business Corporation (selected as a promising small and medium company) | 2016 | • Designated as a work-study company |
| 2002 | • Established Doosung Metal Product Ltd. in Shandong, China | | |
| 2003 | • Renamed the company to Doosung Hwasner Corporation | | |

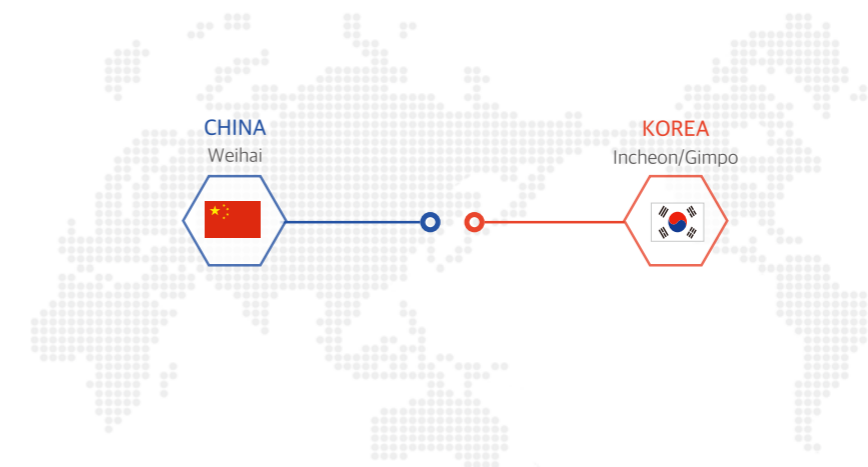

LOCATION

○ KOREA

Doosung Metal Co., Ltd.
INCHEON
514-12 Wondangdae-ro, Seo-gu, Incheon, Korea (196-9, Wanggil-dong)
Tel : +82-32-565-0287~9
Fax : +82-32-563-6840
Homepage : <http://www.ds7.co.kr>

GIMPO
162-2 Daebyeok-ri, Daegot-myeon, Gimpo-si, Gyeonggi-do, Korea

○ CHINA

Weihai Doosung Metal Ltd.
Weihai Bogo Trade Ltd.

Contents

- | | | | |
|--------------|--------------|--------------|--------------------|
| 02-03 | INTROCUCTION | 15-16 | BUILDING MATERIALS |
| 04-08 | ANCHOR | 17 | CASTINGS |
| 09-11 | BOLT | 18 | RUBBER&PLASTIC |
| 12-13 | NUT | 19-21 | FENCE ACESSORY |
| 14 | WASHER&CAP | 22-23 | ETC&FASTENER |

DOOSUNG METAL ANCHOR

ANCHOR TYPE

- Set Anchor
- Strong Anchor (Cut Anchor)
- Wedge Anchor
- Drop in Anchor
- Twisted Anchor
- Stair anchor

ANCHOR TYPE

1. SET ANCHOR

Set anchor is comprised of sleeve and main body. When hitting the bolt, sleeve is withdrawn and fixed more closely with the bore of hole. Especially, it is useful when high level of proof stress is required and is also used for attachment including elevator or guide rail. Depending on the usage, it is classified into sus and steel.

▶ Set Anchor Construction Method

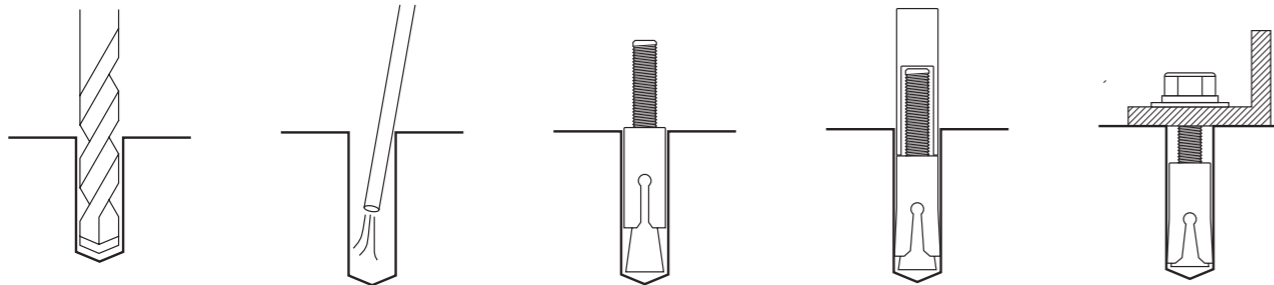

1. Select an appropriate drill in the specifications and make a hole
2. Remove dust in the hole and insert bolt and cap after separating nut and washer
3. Use set anchoring punch, place it on the cap, hit it with hammer, and expand the cap
4. Place attached items, assemble washer and bolt, use spanner, and squeeze the nut

▶ Set Anchor - Size list

| Sleve Size | Full Length L (mm) | Screw Length b (mm) | Cap Length d (mm) | Drill Bit d1 (mm) | Min. Drill Depth (mm) | Max. Tensile Strength (Kgf) | Max. Shear Strength (Kgf) |
|------------|--------------------|---------------------|-------------------|-------------------|-----------------------|-----------------------------|---------------------------|
| M6 (W1/4) | 50 | 20 | 30 | 10 | 33 | 1,080 | 900 |
| | 60 | 25 | 35 | 12 | 38 | 1,835 | 1,200 |
| M8 (W5/16) | 70 | 35 | 40 | 14 | 44 | 2,160 | 2,100 |
| | 100 | 50 | 50 | 17 | 55 | 3,200 | 3,400 |
| M10 (W3/8) | 125 | 80 | 60 | 21.5 | 65 | 4,300 | 5,300 |
| | 150 | 100 | 75 | 25 | 85 | 6,500 | 7,500 |
| M12 (W1/2) | 200 | 130 | 100 | 28 | 110 | 8,000 | 10,000 |
| | 250 | 180 | 120 | 32 | 130 | 10,000 | 12,000 |
| M16 (W5/8) | 200 | 100 | 120 | | | | |
| | 250 | 150 | 150 | | | | |
| M20 (W3/4) | 200 | 100 | 120 | | | | |
| | 250 | 150 | 150 | | | | |
| M22 (W7/8) | 200 | 100 | 120 | | | | |
| | 250 | 150 | 150 | | | | |
| M24 (W1) | 200 | 100 | 120 | | | | |
| | 250 | 150 | 150 | | | | |



▶ Explanation of the usage

Set anchor has supplemented the previous inconvenience for having to hold the location of placement line on the concrete making it convenient to attach objects on the preferred area. Hereupon, it squeezes the nut according to the construction in order and anchors the bolt.

▶ Usage

Guard fence, cooling/heating construction, sign construction, machine installation, and etc.

▶ Texture of the product

Regular steel, stainless steel, and regular molten plate

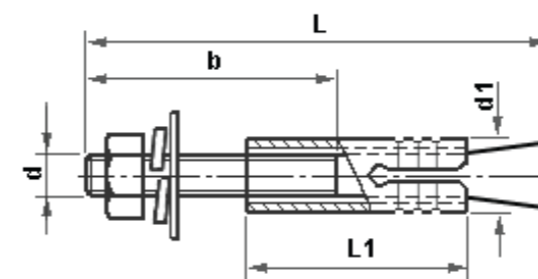

▶ ETC. Anchor



ANCHOR TYPE

2. STRONG ANCHOR (CUT ANCHOR)

Able to attach any types of devices by using the bolt in a random length after laying.



▶ Explanation of the usage

After laying the concrete, strong anchor is optimally used to fix the objects by utilizing hexagon bolt and wires.

▶ Usage

Used for any types of construction including building construction, electricity construction, cooling/heating construction, auxiliary construction for operation, partition construction, ceiling construction, and machine installation construction

▶ Texture of materials

Regular steel, STS steel, and regular molten plate

▶ Strong Anchor Construction Method

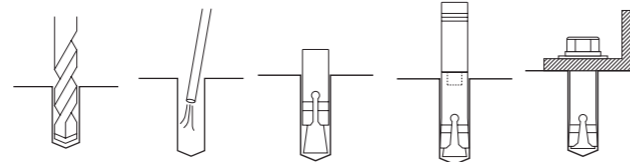
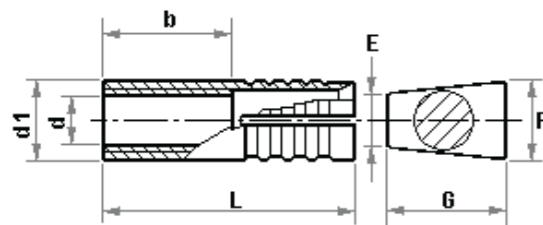

1. Make a hole on the electronic field of anchor with an appropriate drill
2. Put anchor plug to the hole
3. Use punch and hit it with hammer
4. Use tool and squeeze bolt

▶ Strong Anchor - Size list

| Sleeve Size | Total Length L (mm) | Screw Length L1 (mm) | Sleeve Outside(Φ) b (mm) | Pin Size (mm) | | | Drill Size (mm) | Tensile Strength (Kgf) |
|-------------|---------------------|----------------------|--------------------------|---------------|------|------|-----------------|------------------------|
| | | | | e | f | g | | |
| M6 (W1/4) | 30 | 15 | 10.5 | 5.0 | 7.0 | 14.0 | 11.0 | 901 |
| M8 (W5/16) | 35 | 17 | 12.0 | 5.5 | 9.0 | 16.0 | 12.5 | 1,848 |
| M10 (W3/8) | 40 | 18 | 14.3 | 7.5 | 11.0 | 19.0 | 14.5 | 2,220 |
| M12 (W1/2) | 50 | 22 | 17.5 | 9.5 | 14.0 | 23.5 | 18.0 | 3,785 |
| M16 (W5/8) | 60 | 27 | 21.5 | 12.5 | 17.5 | 30.0 | 22.0 | 5,180 |
| M20 (W3/4) | 80 | 35 | 25.5 | 16.0 | 20.0 | 32.0 | 26.5 | 5,500 |
| M22 (W7/8) | 90 | 40 | 28.5 | 19.0 | 25.5 | 40.0 | 29.5 | 6,200 |
| M24 (W1) | 110 | 50 | 31.5 | 20.0 | 30.0 | 45.0 | 33.0 | 8,000 |

ANCHOR TYPE

3. WEDGE ANCHOR

Product available to be processed faster than set anchor without anchor punch.



▶ Explanation of usage

Wedge anchor is the fast and reliable penetrating and attaching anchor. With a cold-forming process, texture is solid and strong. In case of penetrating attachment, base plate hole and anchor hole shall not be consistent without causing problem. Unlike set anchor, it is inserted without particular tools while requiring only about 5 times of rotation to complete the setting. Therefore, it provides faster and safer function than set anchor and also pullout force.

▶ Usage

Anywhere set anchor is used.

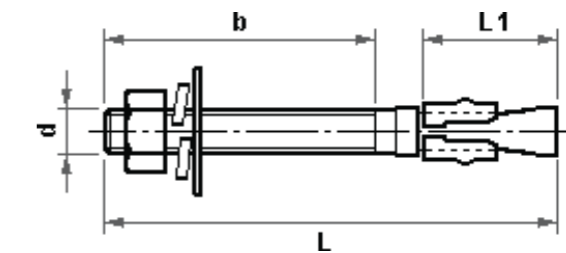

▶ Wedge Anchor - Size list

| Sleeve Size | Total Length L (mm) | Thread Length L1 (mm) | Large Boole Depth b (mm) | Small Fastenable (mm) | Drill Size (mm) | Tensile Strength (Kgf) |
|-------------|---------------------|-----------------------|--------------------------|-----------------------|-----------------|------------------------|
| M8 | 75 | 25 | 65 | 10 | 8 | 2,500 |
| | 95 | 25 | 65 | 30 | | |
| | 115 | 25 | 65 | 50 | | |
| M10 | 80 | 30 | 70 | 10 | 10 | 3,500 |
| | 90 | 30 | 70 | 20 | | |
| | 110 | 35 | 70 | 40 | | |
| | 120 | 35 | 100 | 20 | | |
| M12 | 140 | 35 | 100 | 30 | 12 | 4,250 |
| | 70 | 30 | 60 | 10 | | |
| | 90 | 30 | 70 | 20 | | |
| | 110 | 35 | 90 | 20 | | |
| M16 | 120 | 40 | 110 | 10 | 16 | 7,000 |
| | 145 | 40 | 115 | 30 | | |
| | 160 | 40 | 115 | 45 | | |
| | 220 | 40 | 170 | 50 | | |
| M20 | 150 | 45 | 115 | 35 | 20 | 12,250 |
| | 170 | 45 | 130 | 40 | | |
| | 220 | 45 | 150 | 70 | | |
| | 270 | 45 | 240 | 70 | | |

ANCHOR TYPE

4. DROP IN ANCHOR & ETC ANCHOR

Able to attach any types of devices by using the bolt in a random length after laying.



DOOSUNG METAL BOLT TYPE

BOLT TYPE

- Shank Bolt
- Screw Bolt
- L Anchor / J Anchor
- Full Thread ROD
- Hexagon Bolt
- Top knot Bolt
- U Bolt
- Washbowl Bolt
- Round Bolt
- Hook Bolt
- E.G.I Bolt
- □ Bolt
- Insert

▶ Drop in Anchor - Size list

| Sleve Size | Total Length L (mm) | Screw Length L1 (mm) | Depth of Punching b (mm) | Drill Size (mm) | Pull Out Load (Kgf) |
|------------|---------------------|----------------------|--------------------------|-----------------|---------------------|
| M6 (W1/4) | 25 | 10 | 25 | 8 | 950 |
| M8 (W5/16) | 30 | 14 | 30 | 10 | 1,350 |
| M10 (W3/8) | 40 | 15 | 40 | 12 | 1,950 |
| M12 (W1/2) | 50 | 20 | 50 | 16 | 2,900 |
| M16 (W5/8) | 65 | 25 | 65 | 20 | 4,850 |
| M20 (W3/4) | 80 | 35 | 80 | 25 | 5,900 |



▶ Shank Bolt



▶ Hexagon Bolt



▶ Round Bolt



▶ Insert



▶ Twist Anchor



▶ Stair Anchor



▶ Screw Bolt



▶ Top knot Bolt



BOLT TYPE

BOLT

Product for anchoring the pillars or machines by burying on the concrete floor when installing machines or constructing.

▶ Hook Bolt



▶ E.G.I Bolt



▶ L Anchor / J Anchor



▶ U Bolt



▶ Washbowl Bolt



▶ □ Bolt



▶ Full Thread ROD



▶ U Bolt Metric

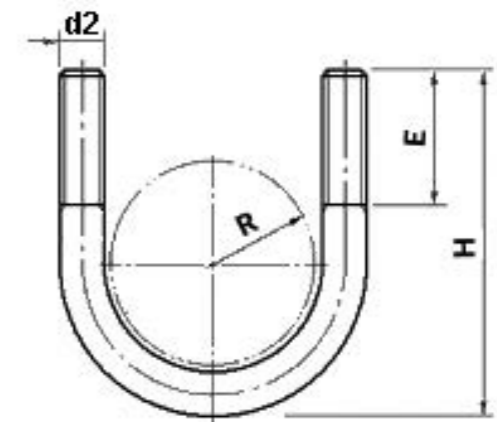

▶ Metric

Unit : mm

| Nominal Size | Out dia of Pipe | U-BOLT | | | | | | | |
|--------------|-----------------|--------|-----|--------|----|--------|----|--------|----|
| | | R | d2 | TYPE A | | TYPE B | | TYPE C | |
| | | | | H | E | H | E | H | E |
| 15 | 21.7 | 12 | M10 | - | - | 39 | 20 | 47 | 30 |
| 20 | 27.2 | 15 | M10 | - | - | 45 | 20 | 53 | 30 |
| 25 | 34.0 | 18 | M10 | - | - | 52 | 20 | 60 | 30 |
| 32 | 42.7 | 23 | M10 | - | - | 60 | 20 | 68 | 30 |
| 40 | 48.6 | 26 | M10 | - | - | 66 | 20 | 74 | 30 |
| 50 | 60.5 | 32 | M10 | - | - | 78 | 20 | 86 | 30 |
| 65 | 76.3 | 40 | M12 | - | - | 98 | 25 | 108 | 35 |
| 80 | 89.1 | 46 | M12 | - | - | 110 | 25 | 120 | 35 |
| 90 | 101.6 | 52 | M12 | - | - | 123 | 25 | 133 | 35 |
| 100 | 114.3 | 59 | M16 | 141 | 50 | - | - | - | - |
| 125 | 139.8 | 72 | M16 | 167 | 50 | - | - | - | - |
| 150 | 165.2 | 85 | M16 | 192 | 50 | - | - | - | - |
| 175 | 190.7 | 98 | M16 | 218 | 50 | - | - | - | - |
| 200 | 216.3 | 111 | M20 | 249 | 60 | - | - | - | - |
| 225 | 241.8 | 124 | M20 | 274 | 60 | - | - | - | - |
| 250 | 267.4 | 137 | M20 | 300 | 60 | - | - | - | - |
| 300 | 318.5 | 163 | M24 | 357 | 70 | - | - | - | - |
| 350 | 355.6 | 181 | M24 | 394 | 70 | - | - | - | - |
| 400 | 406.4 | 207 | M24 | 444 | 70 | - | - | - | - |
| 450 | 457.2 | 233 | M30 | 505 | 85 | - | - | - | - |

DOOSUNG METAL NUT TYPE

NUT TYPE

- Flange Nut
- Round Connecting Nut
- Cap Nut
- Hex Connecting Nut
- Wing Nut
- Spring Nut
- Hex Nut

▶ Flange Nut



▶ Round Connecting Nut



▶ Cap Nut



▶ Hex Connecting Nut



▶ Wing Nut



▶ Spring Nut



▶ Hex Nut Metric

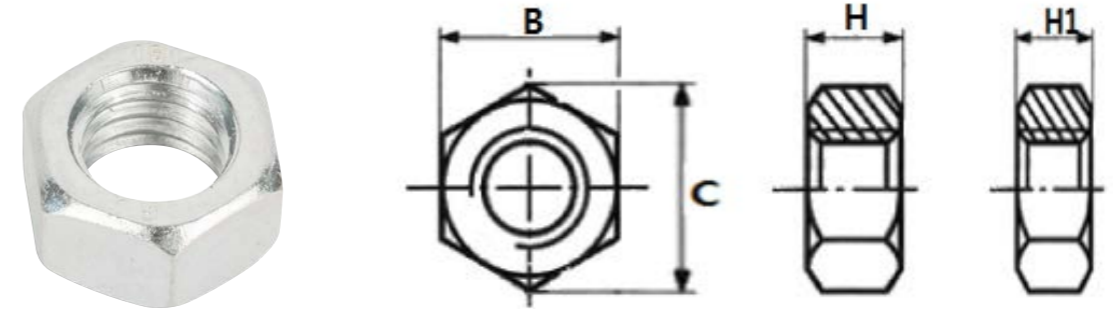

▶ Metric

Unit : mm

| Bolt Diameter | H | | | | H ₁ | | | | B | | | | C | Pitch | |
|---------------|-------|-----------|-------------|---------|----------------|-----------|-------------|---------|-------|-----------|-------------|---------|------|--------|------|
| | Basic | Tolerance | | | Basic | Tolerance | | | Basic | Tolerance | | | | Coarse | Fine |
| | | Finish | Semi-Finish | Regular | | Finish | Semi-Finish | Regular | | Finish | Semi-Finish | Regular | | | |
| M5 | 5 | -0.30 | -0.48 | ±0.6 | 3.6 | | | | 10 | 0 | 0 | 0 | 11.5 | 1 | - |
| M8 | 6.5 | | | | 5 | 0 | 0 | ±0.6 | 13 | 0 | 0 | 0 | 15 | 1.25 | 1 |
| M10 | 8 | 0 | 0 | ±0.8 | 6 | -0.3 | -0.48 | | 17 | -0.25 | -0.7 | -0.7 | 19.6 | 1.5 | 1.25 |
| M12 | 10 | -0.36 | -0.58 | | 7 | | | | 19 | | | | 21.9 | 1.75 | 1.25 |
| (M14) | 11 | | | | 8 | 0 | 0 | ±0.8 | 22 | | | | 25.4 | 2 | 1.5 |
| M16 | 13 | | | | 10 | -0.70 | -0.58 | | 24 | 0 | 0 | 0 | 27.7 | 2 | 1.5 |
| (M18) | 15 | 0 | 0 | ±0.9 | 11 | | | | 27 | -0.35 | -0.8 | -0.8 | 31.2 | 2.5 | 1.5 |
| M20 | 16 | -0.43 | -0.70 | | 12 | | | | 30 | | | | 34.6 | 2.5 | 1.5 |
| (M22) | 18 | | | | 13 | 0 | 0 | ±0.9 | 32 | | | | 37 | 2.5 | 1.5 |
| M24 | 19 | | | | 14 | -0.43 | -0.70 | | 35 | | | | 41.6 | 3 | 2 |
| (M27) | 22 | | | | 16 | | | | 41 | 0 | 0 | 0 | 47.3 | 3 | 2 |
| M30 | 24 | 0 | 0 | ±1.0 | 18 | | | | 45 | -0.4 | -1.0 | -1.0 | 53.1 | 3.5 | 2 |
| (M33) | 26 | -0.52 | -0.84 | | 20 | | | | 50 | | | | 57.7 | 3.5 | 2 |
| M36 | 29 | | | | 21 | 0 | 0 | ±1.0 | 55 | 0 | 0 | 0 | 63.5 | 4 | 3 |
| M42 | 34 | | | | 25 | -0.52 | -0.84 | | 65 | -0.45 | -1.2 | -1.2 | 75 | 4.5 | - |

▶ Unified

Unit : inch

| Nominal Size or Basic Major Dia of Thread | B | | | C | | H | | | H ₁ | | | Runout or Bearing Surface-FIR | | |
|---|--------------------|---------|-------|----------------------|-------|--------------------|---------|-------|--------------------------|-------|-------|------------------------------------|-------|-------|
| | Width Across Flats | | | Width Across Corners | | Thickness Hex Nuts | | | Thickness Heavy Mex Nuts | | | Hex Nuts with Specified proof Load | | |
| | Basic | Max | Min | Max | Min | Basic | Max | Min | Basic | Max | Min | Max | Min | |
| 1/4 | 0.2500 | 7/16 | 0.438 | 0.428 | 0.505 | 0.488 | 7/32 | 0.226 | 0.212 | 5/32 | 0.164 | 0.150 | 0.015 | 0.010 |
| 5/16 | 0.3125 | 1/2 | 0.500 | 0.489 | 0.577 | 0.557 | 17/64 | 0.273 | 0.258 | 3/16 | 0.195 | 0.180 | 0.016 | 0.011 |
| 3/8 | 0.3150 | 9/16 | 0.562 | 0.551 | 0.650 | 0.628 | 21/54 | 0.337 | 0.320 | 7/32 | 0.227 | 0.210 | 0.017 | 0.012 |
| 7/16 | 0.4375 | 11/16 | 0.688 | 0.675 | 0.794 | 0.768 | 3/8 | 0.385 | 0.365 | 1/4 | 0.260 | 0.240 | 0.018 | 0.013 |
| 1/2 | 0.5000 | 3/4 | 0.750 | 0.736 | 0.866 | 0.840 | 7/16 | 0.448 | 0.427 | 5/16 | 0.323 | 0.302 | 0.019 | 0.014 |
| 9/16 | 0.5625 | 7/8 | 0.875 | 0.861 | 1.010 | 0.982 | 31/64 | 0.496 | 0.473 | 5/16 | 0.324 | 0.301 | 0.020 | 0.015 |
| 5/8 | 0.6250 | 15/16 | 0.938 | 0.922 | 1.083 | 1.051 | 35/64 | 0.559 | 0.535 | 3/8 | 0.387 | 0.363 | 0.021 | 0.016 |
| 3/4 | 0.7500 | 1-1/8 | 1.125 | 1.088 | 1.299 | 1.240 | 41/64 | 0.665 | 0.617 | 27/64 | 0.445 | 0.398 | 0.023 | 0.018 |
| 7/8 | 0.8750 | 1-5/8 | 1.312 | 1.269 | 1.516 | 1.447 | 3/4 | 0.776 | 0.274 | 31/64 | 0.510 | 0.458 | 0.025 | 0.020 |
| 1 | 1.0000 | 1-1/2 | 1.500 | 1.450 | 1.732 | 1.653 | 55/64 | 0.887 | 0.831 | 35/64 | 0.575 | 0.519 | 0.027 | 0.022 |
| 1-1/8 | 1.1250 | 1-11/16 | 1.688 | 1.631 | 1.949 | 1.859 | 31/32 | 0.999 | 0.939 | 39/64 | 0.639 | 0.579 | 0.030 | 0.025 |
| 1-1/4 | 1.2500 | 1-7/8 | 1.875 | 1.812 | 2.165 | 2.066 | 1-1/16 | 1.094 | 1.030 | 23/32 | 0.751 | 0.687 | 0.033 | 0.028 |
| 1-3/8 | 1.3750 | 2-1/16 | 2.062 | 1.994 | 2.382 | 2.273 | 1-11/64 | 1.206 | 1.138 | 25/32 | 0.815 | 0.747 | 0.036 | 0.031 |
| 1-1/2 | 1.5000 | 2-1/4 | 2.250 | 2.175 | 2.598 | 2.480 | 1-9/32 | 1.317 | 1.245 | 27/32 | 0.880 | 0.808 | 0.039 | 0.034 |

DOOSUNG METAL WASHER & CAP

WASHER & CAP TYPE

- Spring Washer
- Press Cap (Regular)
- Flat Washer
- Press Long Cap
- Square Washer
- Pipe Cap

DOOSUNG METAL BUILDING MATERIALS

BUILDING MATERIALS TYPE

- KP Bolt & Nut
- Casting and Wing nut
- Bolt and Nut for construction
- Welding Stud/Arc shield
- Ground ROD
- Flat Tie
- Al Form Tie
- Sepa Tie
- Al Form Sepa Tie
- Sepa Bolt
- Tie Bolt

▶ Spring Washer



▶ Press Cap (Regular)

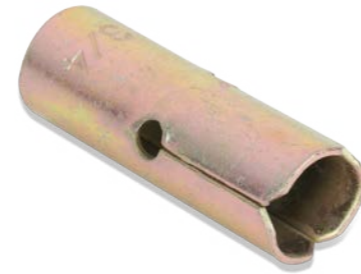

▶ KP Bolt & nut



▶ Casting and Wing Nut



▶ Flat Washer



▶ Press Long Cap



▶ Bolt and Nut for construction



▶ Welding Stud/Arc Shield



▶ Square Washer



▶ Pipe Cap



▶ Ground ROD



BUILDING MATERIALS TYPE

BUILDING MATERIALS

Flat tie, as a representative construction material, is a material inserted between euroforms. It is used to adjust the interval depending on the length.

▶ Flat Tie



▶ Al Form Tie



▶ Sepa Tie



▶ Al Form Sepa Tie



▶ Sepa Bolt



▶ Tie Bolt



DOOSUNG METAL CASTINGS

CASTINGS TYPE

- Turnbuckle
- Wire Clip
- Eye Bolt
- Eye Nut

▶ Turnbuckle



▶ Wire Clip



▶ Eye Bolt



▶ Eye Nut



DOOSUNG METAL RUBBER & PLASTIC

RUBBER & PLASTIC TYPE

- Channel Cap
- Full Thread ROD Cap
- Fisher
- Wall Plug

DOOSUNG METAL FENCE ACCESSORY

FENCE TYPE

- Base Plate
- Stainless Hex Bolt and Nut
- Stainless Set Anchor
- Anchor Type Pillar
- Basic Type Pillar
- Mesh Fence Net
- Stainless U Band (Flat Clip)
- Stainless Fence Bolt
- Stainless Hex Nut

▶ Channel cap



▶ Full thread ROD Cap



▶ Fisher



▶ Wall Plug



▶ Base Plate



▶ Stainless Hex Bolt and Nut



▶ Stainless U Band (Flat Clip)



▶ Stainless Fence Bolt



▶ Stainless Set Anchor



▶ Stainless Hex Nut



FENCE TYPE

MESH FENCE

It is a practical product that is used in a wide range including home, government buildings, farms, factory, physical facilities, and protection for industrial facilities and stream.

▶ How to construct each pillar of mesh fence



Anchor Type Pillar

- Install in the cement and concrete area. Installation is available with square with at least 14cm of width
Available to manufacture 5m in 60m from the base plate (Base 60cm/ 90cm/ 1.2cm/ 1.5cm/ 1.8cm/2.0cm)
- Height of pillar is from the base plate to the top.

Basic Type Pillar

- Install in the soil or gravel pillar. After excavating the ground, cement or ready-mixed concrete (foundation stone) are used to fix the pillar
- Basic pillar is delivered with the size of 90cm including the height of 60cm and areas for it to be buried for 30cm at the bottom

▶ Mesh fence pillar, size, and related parts

Anchor type

- Usage**
- Anchor bolt-type
- Areas for installation**
- Cement area
- Size**
- 76.3X2.0t
 - 76.3X1.4t
- Fixed on the ground**
- Fix the anchor bolt
- Parts**
- Anchor bolt
 - Fixing band
 - Bolt and nut



Basic type

- Usage**
- Bed excavation
- Areas for installation**
- Dirt or gravel area
- Size**
- 76.3X2.0t
 - 76.3X1.4t
- Fixed on the ground**
- 30cm
- Parts**
- Fixing band
 - Bolt and nut



▶ Mesh Fence parts

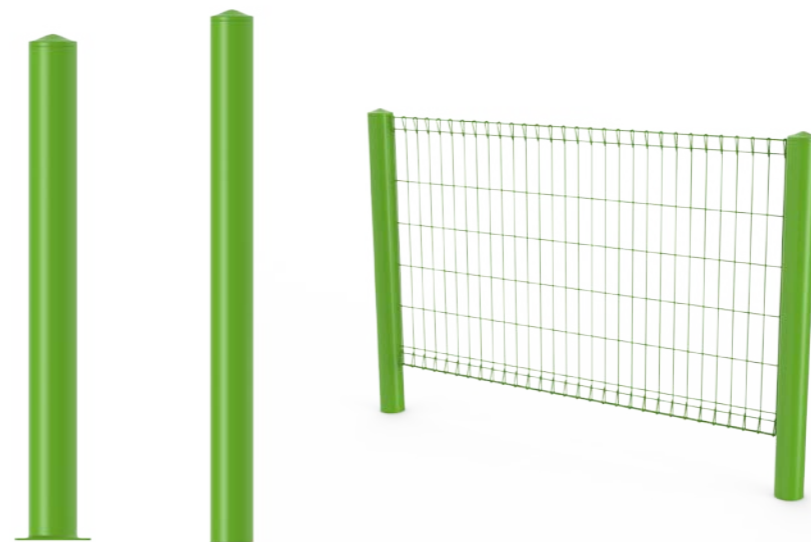

Anchor type
76.3X2.0t
76.3X1.4t

Basic type
76.3X2.0t
76.3X1.4t

Mesh Fence net

Mesh Fence net

- As a net connecting through the clip on the pillar, height is generally from 600mm to 200mm. It is standardized in 150mm in one column and 50mm for width
- Thickness is 4.3t that is electronically welded. Light green, white, and all other colors are usable for manufacturing.

▶ Clip (Mesh Anchoring band)

32X25X0.6t



▶ Stainless Hex Bolt and Nut (mesh fixing 3/T)

8X110mm



▶ Stainless Anchor

3/8X70mm



▶ Stainless Hex Nut

8mm



DOOSUNG METAL ETC&FASTENER

ETC&FASTENER TYPE

- Locking device
- Bracket (Two-Edges type)
- Hole down Clamp (Separated type)
- Bracket (Two-Edges type)
- Angle
- Duct Channel
- Cover Clamp
- Hole-down Clamp (Assembled type)
- Non-Pin Hanger (G-Hanger)
- Separate Clamp
- Pipe Hanger
- H Beam Clamp

ETC&FASTENER TYPE

ETC&FASTENER

Fasner is a welding for bolt or nut sets that are used in binding for steel materials.

▶ Locking Device



▶ Bracket (Single Edge Type)



▶ Cover Clamp



▶ Hole-Down Clamp (Assembled type)



▶ Hole down Clamp (Separated type)



▶ Bracket (Two-Edges type)



▶ Non-Pin Hanger (G-Hanger)



▶ Separate Clamp



▶ Angle



▶ Duct Channel



▶ Pipe Hanger



▶ H Beam Clamp

